

CITY OF MURRAY CONTROL MONUMENT CARD

DESIGNATION: C8 GPS
TYPE: CONCRETE MONUMENT W/ CITY DISK
DATE SET: JUNE 1997 QUAD: MURRAY, KY.
HORIZONTAL DATUM: NAD-83 VERTICAL DATUM: NAVD-88
STATE: KENTUCKY COUNTY: CALLOWAY ZONE: KY. S 1602

NORTHING: 1743980.24 FT
EASTING: 881952.97 FT
ELEVATION: 542.99 FT (GPS)
LATITUDE: N 36°35'21.45637" LONGITUDE: W 088°20'00.98959"
SCALE: CONVERGENCE:
PLANE AZI. TO AZI. MARK:

To Reach: From the intersection of Doran Rd. and
Azaela Rd., go south on Doran Rd. for 40 feet to
the station on the right.

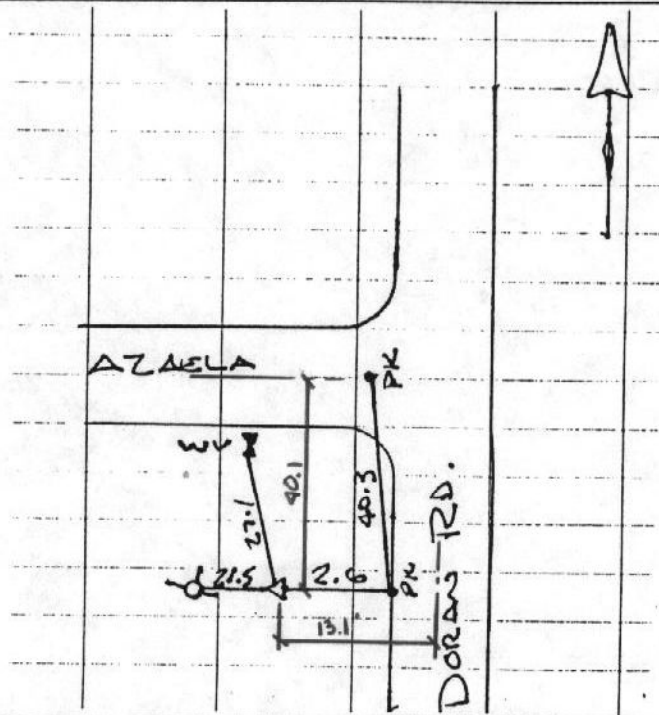

NOT TO SCALE

GRW Aerial Surveys, Inc.
801 Corporate Dr. Lexington Ky. 40503
(606)223-3999